



- **Surface Mount Seam Weld Package**
- **Excellent Reliability Performance**
- **Ultra Miniature Package**

Surface mount 2.5 x 2.0 x 0.6mm Crystal Unit

XTL1012

**24.265 MHz
Crystal Unit**



Electrical Characteristics

Characteristic	Sym	Notes	Minimum	Typical	Maximum	Units
Nominal Frequency	F _O			24.26500		MHz
Mode of Oscillation			Fundamental			
Storage Temperature Range			-40		+85	°C
Operating Temperature Range			-40		+85	°C
Frequency Stability over Operating Temperature Range			±15ppm (referred to the value at 25°C)			
Frequency Make Tolerance	F _L		±10ppm @ 25°C ±3°C			
Equivalent Series Resistance	ESR				60	Ω
Nominal Drive Level				10		uW
Shunt Capacitance	C _O				1	pF
Load Capacitance	C _L			12		pF
Aging			1ppm/year			
Lid Symbolization (in addition to Lot and/or Date Codes)			2D <u>YW</u>			



CAUTION: Electrostatic Sensitive Device. Observe precautions for handling.

Notes:

1. The design, manufacturing process, and specifications of this device are subject to change without notice.

SM2520-4 Case

4-Terminal Surface-Mount Case 2.5 x 2.0 mm Nominal Footprint

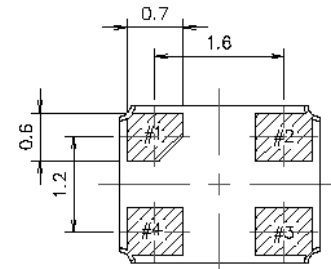
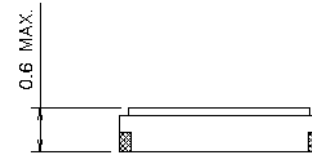
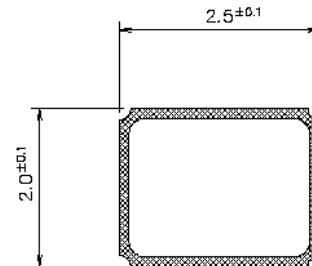
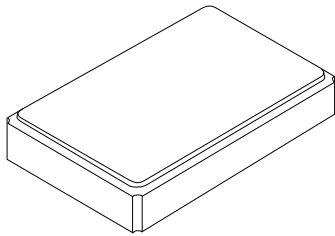

Package Dimensions (mm)

Electrical Connections

Pin	Connection
1	IN/OUT
2	GND
3	IN/OUT
4	GND

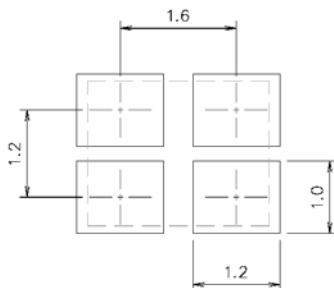

Land Pattern (mm)

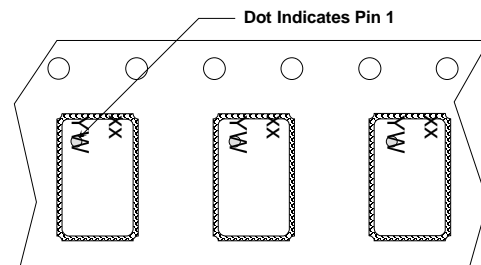

Package Orientation in Carrier Tape